



Slant Fin Corp.  
100 Forest Drive  
Greenvale, NY  
11548 USA  
Technical Assistance:  
(516) 484-2600  
Fax: (516) 484-5921  
www.slantfin.com  
**CHS-FS-40**

## CHS FLOOR STAND (P/N 818-171 & 818-169)

### INSTALLATION INSTRUCTIONS

Version Date: 2014-09-03

#### APPLICABLE MODELS:

P/N 818-169 – Floor Stand CHS300-399

- Intended for use with CHS300-399 boiler models

P/N 818-171 – Floor Stand CHS85-250

- Intended for use with CHS85-250 boiler models
- DO NOT use with CHS300-399 boiler models



Floor Stand P/N 818-171-000 is not to be used with CHS300-399 boiler models. Failure to comply may lead to serious injury or property damage.

#### Introduction

The CHS Floor Stands are intended for use with Slant/Fin boiler models CHS-85 to CHS-399; they are **NOT** intended for use with other boiler models. It is the installer's responsibility to ensure the floor stand is assembled and the boiler is mounted in accordance with these instructions. Check Floor Stand kit contents to ensure all components are included, prior to commencing assembly. Contact Slant/Fin if assistance is required.

#### Overall Assembled Dimensions

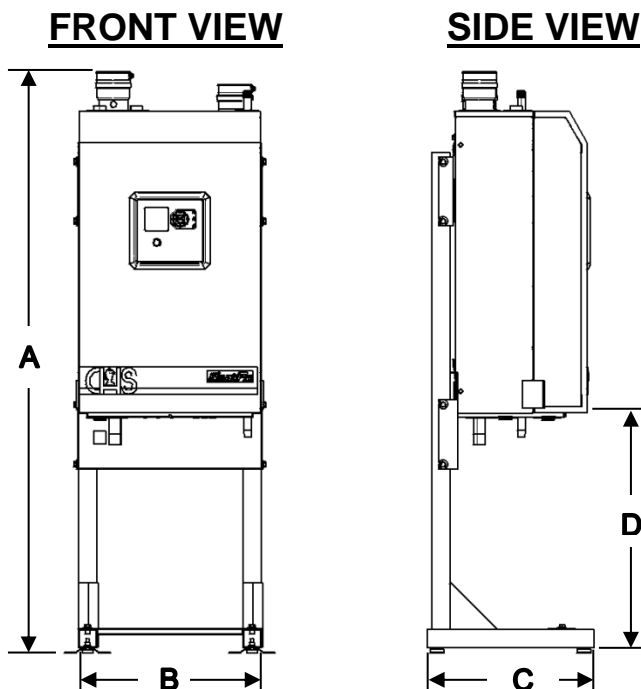

Model	Dimensions <sup>1</sup>		
	A	C	D
CHS85-110	63-1/2	18-1/4	25-3/4
CHS155-250	63	18-1/4	25-3/4
CHS300-399	63-1/4	18-1/4	23-1/8

#### Notes:

<sup>1</sup> All dimensions are in inches.

<sup>2</sup> Dimension **B** is dictated by the width of the stand;

- P/N 818-169 CHS300-399 = 26"
- P/N 818-171 CHS85-250 = 20"

## Kit Contents

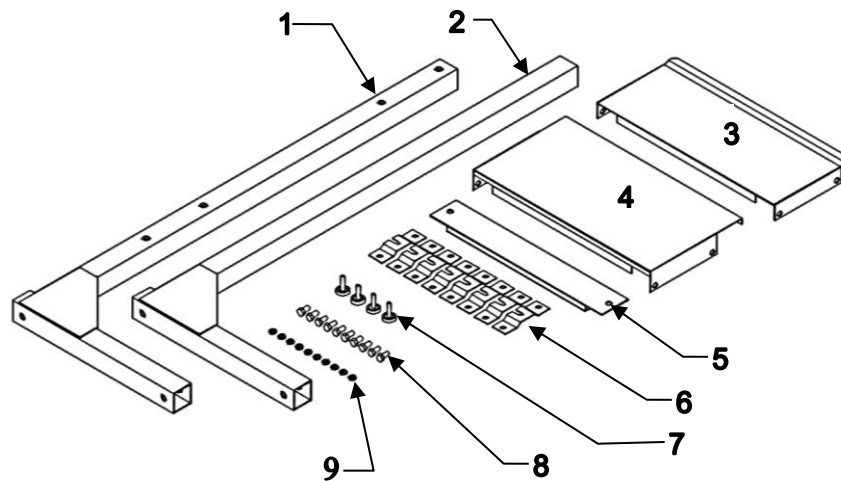

### No. Item Description

1. Left Rail
2. Right Rail
3. Top Cross Member
4. Middle Cross Member
5. Bottom Cross member
6. Floor Anchor Brackets x 8
7. Leveling Legs x 4
8. 3/8" x 3/4" Bolts x10
9. 3/8" Split-lock Washers x 10
10. #14 x 3/4" Drill-point screws x 2 (not shown)

## Assembly Instructions (Steps 1-4)

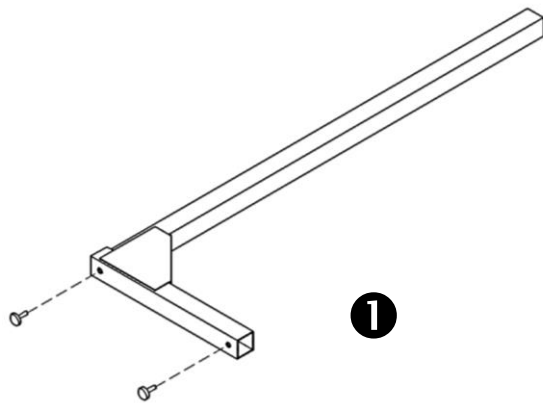

1. Install Leveling Legs into the bottom of the Right and Left Rails. Leave a minimum of 1/2" of the Leveling leg exposed for attaching floor anchors in step 5.

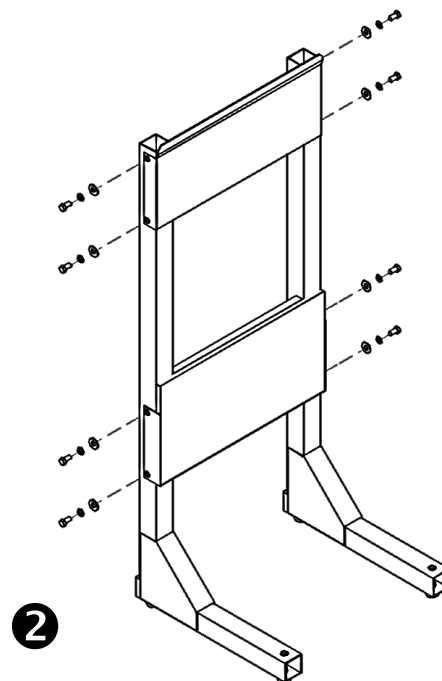

2. Connect the Top and Middle Cross Members to the Rails using eight (8) of the 3/8" x 3/4" bolts and 3/8" Split-lock Washers.

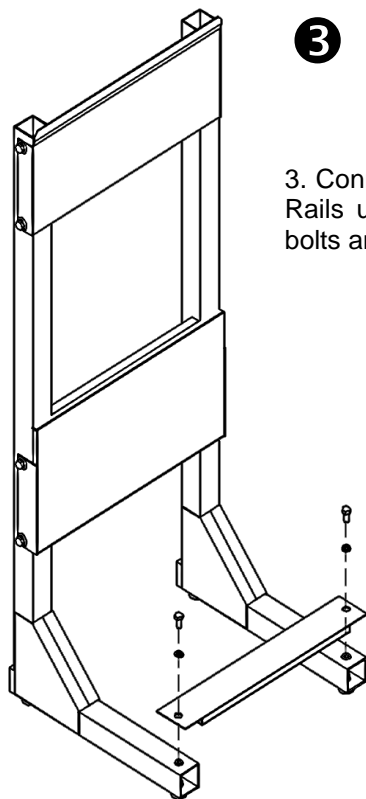

3. Connect the Bottom Cross Member to the Rails using the remaining two - 3/8" x 3/4" bolts and 3/8" Split-lock Washers.

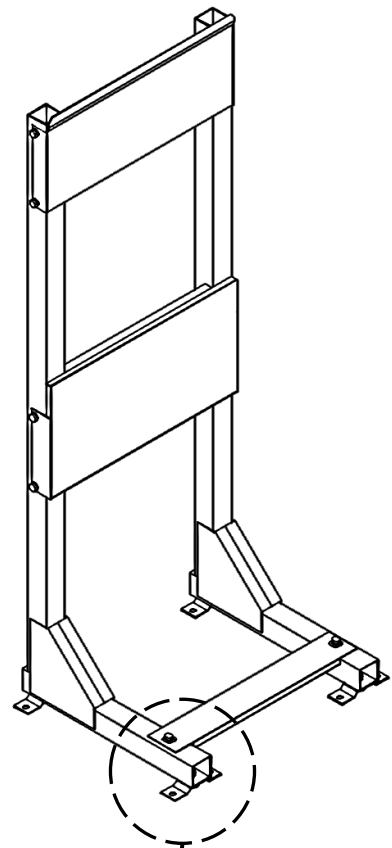

4. Tighten all the bolts; position the stand in its final location. Using a level, adjust the 4 Leveling Legs to attain a level stand from front-to-back and side-to-side.

5

5. Overlap the Floor Anchor Brackets on the Leveling leg as shown with the 'U' cuts facing each other. Fasten the Floor Anchor Brackets to the floor using field supplied anchors. Perform this exact process to each leveling leg.

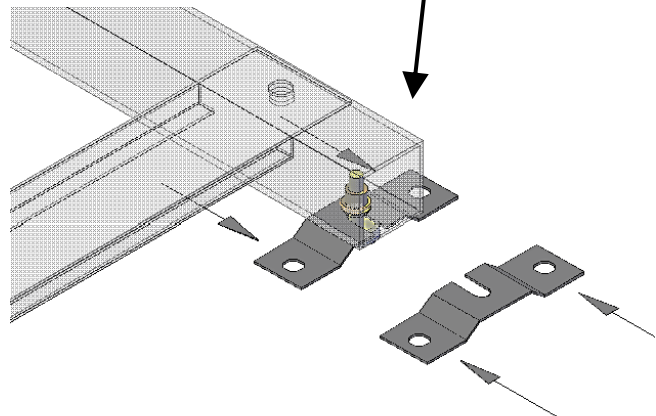

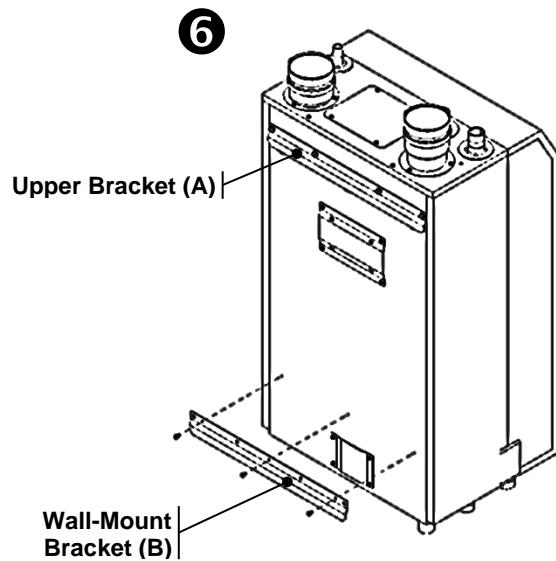
**Boiler Mounting Instructions (Steps 5-9)**

6. Remove the Wall-Mount Bracket (B) from the back of the boiler and discard; keep the screws for use in step 8. Upper Bracket (A) remains on the boiler.

7. With the help of an assistant, hook the Upper Bracket (A), mounted to the boiler, onto the Top Cross Member of Floor Stand – ensure the bracket fully engages. See Reverse View.

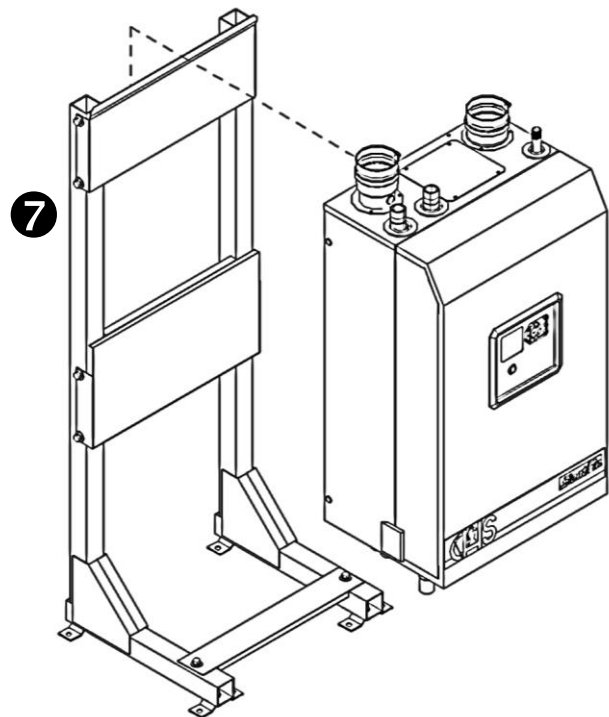

**Reverse View (Step 7)**

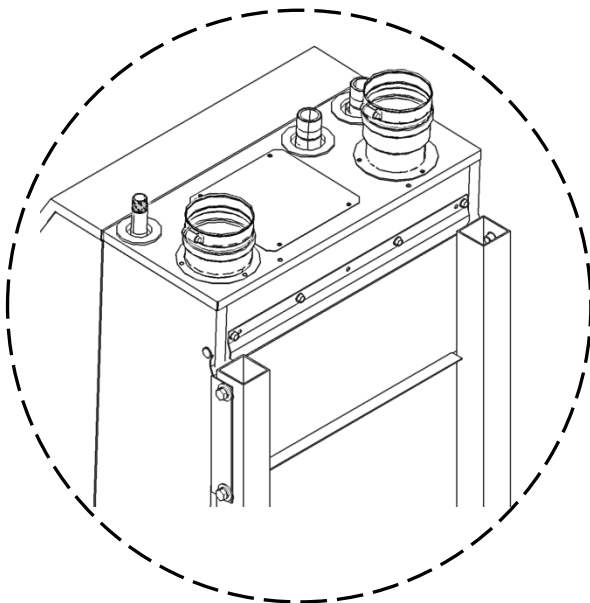

Upper bracket (A) hooked over Top Cross Member

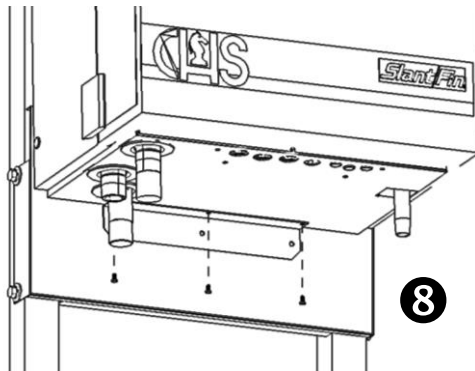

8. Fasten the Boiler Support Bracket to the bottom of the boiler using the screws removed in step 6. Before tightening, ensure the boiler is plumb.

9

9. Secure the Boiler Support Bracket to the Middle Cross Member using #14 x 3/4" drill-point screws.

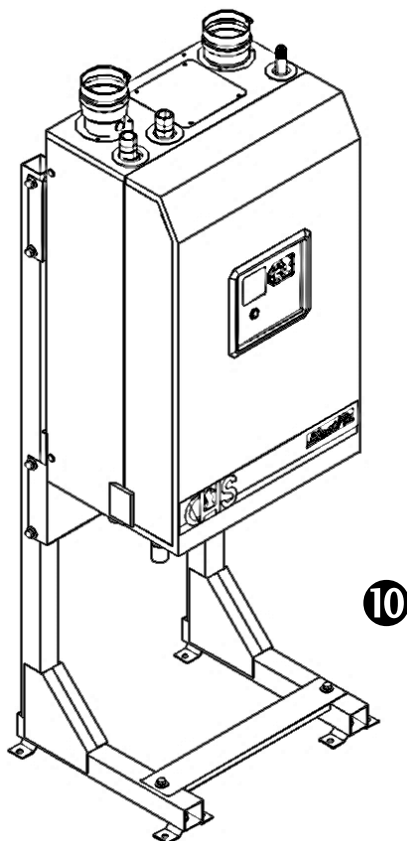
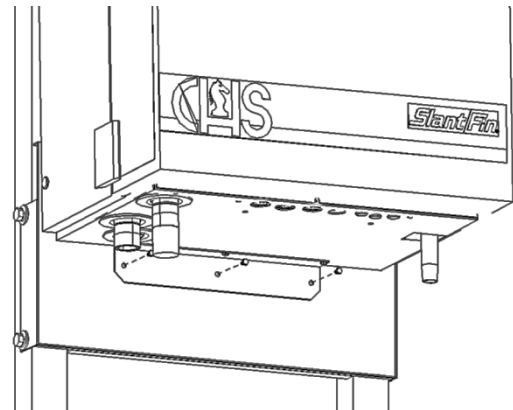

10. Check to ensure the boiler is level – correct if necessary using Leveling Legs. Proceed with the boiler installation – see detailed Installation Instruction provided with the boiler.

## Supplemental Instructions for CHS – Floor Stand Twinning Kit (P/N 818 220)

CHS's Floor Stand Twinning Kit is designed to connect CHS Floor Stands together, side by side and provide the required boiler spacing for correct installation of the CHS 300-399 Common Venting. One Twinning Kit is needed to connect two (2) Floor Stands together; additional Twinning Kits are required to connect additional Floor Stands together (e.g. two Twinning Kits for three Floor Stands).



When connecting Floor Stands together, using the Twinning Kit, do so prior to installing the boiler on the Floor Stands. Failure to follow this warning may result in serious injury or property damage.

### Twinning Kit Contents

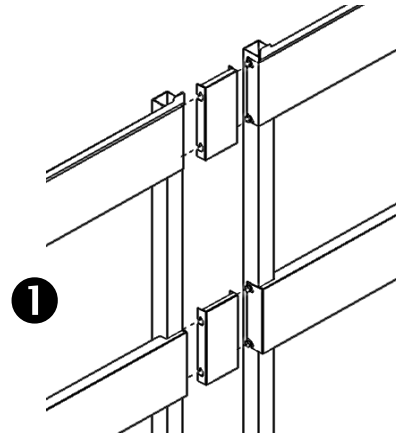
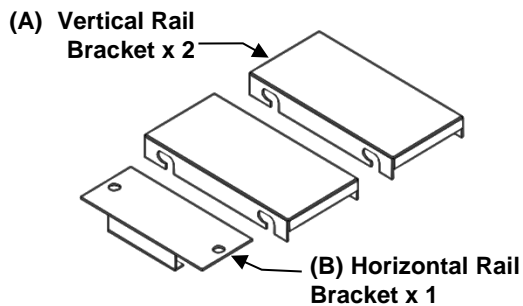

1). Loosen (DO NOT Remove) the bolts on the Top and Middle Cross Members. Slide Vertical Rail Bracket (A) over the loose bolts then tighten.

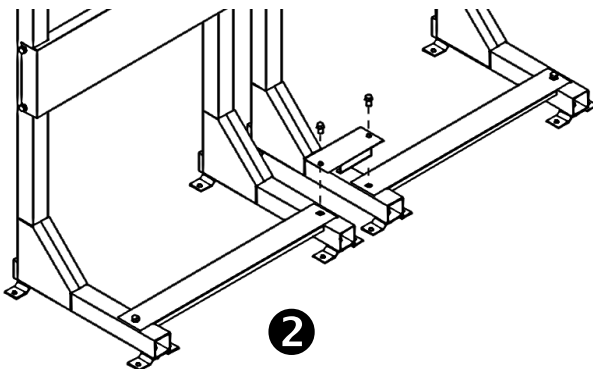

2. Remove bolts and split-lock washers from the Bottom Cross Member. Place the Horizontal Rail Bracket (B) over the holes and reinstall the bolt and Split-lock Washers.

3. Check to ensure the stands are level – correct if necessary using Leveling Legs. Proceed with the boiler installation – see detailed Installation Instructions provided with the boiler.

