

PARTS LIST

LIBERTY® PACKAGED CAST-IRON OIL BOILERS

Table 1: WATER BOILER PARTS LIST, P, PT AND PPT

ITEM	DESCRIPTION	QTY	L-20	L-30	L-40	L-50	L-60	L-70
1A	Casting subassembly water, less plate	1	430712	430713	430714	430715	430716	430717
1B	Casting subassembly water, extended boss less plate	1	430712	430713	430714	430715	430716	430717
1C	Casting subassembly water, solid front (NO provision for tankless)	1	430702	430703	430704	430705	430706	430707
2	Burner mounting plate C.I.	1	430014	430014	430014	430014	430014	430014
3	Front refractory insulation	1	430018	430018	430018	430018	430018	430018
4	Target wall	1	430029	430029	430029	430029	430029	430029
4A	Blanket, insulation	1	—	—	—	—	430059	430060
5	Stud 3/8-16 x 1-7/8 steel interrupted thread	4	430115	430115	430115	430115	430115	430115
6	Sealant material 1/4" dia. 50" long, mtg. plate	1	430136	430136	430136	430136	430136	430136
7	Hex nut 3/8-16 steel	7	400328	400328	400328	400328	400328	400328
8	Washer flat 3/8 nom. steel	13	430117	430117	430117	430117	430117	430117
9	Blank plate, tankless	1	430031	430031	430031	430031	430031	430031
10	Gasket 1/8 thick	1	430071	430071	430071	430071	430071	430071
11	Cap screw 3/8-16 x 3/4 lng. hex hd.	6	400200	400200	400200	400200	400200	400200
12	Flue collector	1	430032	430033	430034	430035	430036	430037
12A	Flue collector sealant	1	430147	430147	430147	430147	430147	430147
13	Carriage bolt 1/4-20 x 2-1/2 long	1	430108	430108	430108	430108	430108	430108
13A	Wing nut 1/4-20	1	400147	400147	400147	400147	400147	400147
13B	Washer 1/4"	1	909783071	909783071	909783071	909783071	909783071	909783071
14	Clean out door CRS	1	430019	430019	430019	430019	430019	430019
15	Observation door C.I.	1	402185	402185	402185	402185	402185	402185
16	Self tapping screw, 1/4-20 x 1 long hex slotted hd.	3	400217	400217	400217	400217	400217	400217
17	Stud 3/8-16 x 1-3/8 steel interrupted thread	3	430107	430107	430107	430107	430107	430107
18	Jacket, insulated top	1	430362	430363	430364	430365	430366	430367
19	Jacket, insulated side	2	430372	430373	430374	430375	430376	430377
20	Jacket, insulated rear	1	430371	430371	430371	430371	430371	430371
21	Jacket, insulated front, water	1	430370	430370	430370	430370	430370	430370
22	Emblem - Slant/Fin	1	401020	401020	401020	401020	401020	401020
24	Sheet metal screw #8 x 3/8 AB hex slot hd.	14	908116021	908116021	908116021	908116021	908116021	908116021
25	Relief valve - H.W. 30 PSI Conbraco or Watts	1	400103	400103	400103	400103	400103	400103
26	Nipple 3/4 x 2 long (for relief valve)	1	400225	400225	400225	400225	400225	400225
27	Drain valve 3/4 NIBCO #74	1	400201	400201	400201	400201	400201	400201
28	Reducing bushing 1-1/2 NPT x 3/4 NPT	1	902179321	902179321	902179321	902179321	902179321	902179321
29	Tridicator (0-75 PSI)	1	910373061	910373061	910373061	910373061	910373061	910373061
30	Control, hi limit Hon. L4080B1253 or W/R11B83-1	1	—	—	—	—	—	410699
30A	Control, high/low limit L4081A (PT)	1	—	—	—	—	410529	410529
30B	Control, hi limit circ. HON L8148A (P)	1	400096	400096	400096	400096	400096	—
30C	Control, hi-lo limit-circ. HON L8124C1094 (PT)	1	400095	400095	400095	400095	—	—
31	Well 1/2 NPT x 1-1/2 ins.	1	410569	410569	410569	410569	410569	410569
32	Thermostat - 24V Hon. T822D1537	1	—	400101	400101	400101	400101	400101
33	Primary control, Honeywell R8184G	1	400119	400119	400119	400119	400119	N.A.
34	Burner assembly: Beckett	1	4301522	4301532	4301542	4301552	—	—
34A	Burner assembly: Carlin	1	4301520	4301530	4301540	4301550	4301560	4301570
34B	Burner assembly: Riello	1	—	4301533	4301543	4301553	—	—
35	Tankless heater assy. (optional)	1	430072	430073	430074	430074	430075	430075
36	Gasket, Beckett burner	1	—	430172	430172	430172	—	—
36A	Gasket, Carlin burner	1	430173	430173	430173	430173	430173	430173
37A	Circulator, Taco 007	1	7902022	7902022	7902022	7902022	7902022	7902022
37B	Circulator, Grundfos UP-15-42F	1	7902021	7902021	7902021	7902021	7902021	7902021
37C	Circulator, B&G NRF-22	1	7902023	7902023	7902023	7902023	7902023	7902023
37D	Circulator, Taco 0010	1	—	—	—	430102	430102	—

Replacement Parts are available from
Slant/Fin Corporation
 100 Forest Drive at East Hills
 Greenvale, NY 11548



PUBLICATION NO. L-10PL
 Printed in U.S.A. 1197
 Part No. 430309

Table 2. STEAM BOILER PARTS LIST, PZ AND PZT

ITEM	DESCRIPTION	QTY	L-30	L-40	L-50	L-60	L-70
1	Casting subassembly steam, less plate	1	432033	432034	432035	432036	432037
2	Burner mounting plate C.I.	1	430014	430014	430014	430014	430014
3	Front refractory insulation	1	430018	430018	430018	430018	430018
4	Target wall	1	430029	430029	430029	430029	430029
5	Stud 3/8-16 x 1-7/8 steel interrupted thread	4	430115	430115	430115	430115	430115
6	Sealant material 1/4" dia. 50" long, mtg. plate	1	430136	430136	430136	430136	430136
7	Hex nut 3/8-16 steel	7	400328	400328	400328	400328	400328
8	Washer flat 3/8 nom. steel	19	430117	430117	430117	430117	430117
9	Blank plate, tankless steam	1	430021	430021	430021	430021	430021
10	Gasket 1/8 thick	1	430070	430070	430070	430070	430070
11	Cap screw 3/8-16 x 3/4 long hex hd.	12	400200	400200	400200	400200	400200
12	Flue collector	1	430033	430034	430035	430036	430037
12A	Flue collector sealant	1	430147	430147	430147	430147	430147
13	Carriage bolt 1/4-20 x 2-1/2 long	1	430108	430108	430108	430108	430108
13A	Wing nut 1/4-20	1	400147	400147	400147	400147	400147
13B	Washer 1/4"	1	909783071	909783071	909783071	909783071	909783071
14	Clean out door CRS	1	430019	430019	430019	430019	430019
15	Observation door C.I.	1	402185	402185	402185	402185	402185
16	Self tapping screw, 1/4-20 x 1 long hex slotted hd.	3	400217	400217	400217	400217	400217
17	Stud 3/8-16 x 1-3/8 steel interrupted thread	3	430107	430107	430107	430107	430107
18	Jacket, insulated top	1	430363	430364	430365	430366	430367
19	Jacket, insulated side	2	430373	430374	430375	430376	430377
20	Jacket, insulated rear	1	430371	430371	430371	430371	430371
21	Jacket, insulated front, steam	1	430360	430360	430360	430360	430360
22	Emblem - Slant/Fin	1	401020	401020	401020	401020	401020
24	Sheet metal screw #8 x 3/8 AB hex slot hd.	14	908116021	908116021	908116021	908116021	908116021
25	Safety valve Conbraco 13-501 or Watts 315	1	400107	400107	400107	400107	400107
26	Water gauge set 1/2 NPT	1	402036	402036	402036	402036	402036
27	Glass - 5/8 dia. x 5-3/4 long	1	430132	430132	430132	430132	430132
28	Rod - 3/16 dia. x 7-3/4 long	2	430134	430134	430134	430134	430134
29	Pressure gauge - 30 PSI 2-1/2	1	910374051	910374051	910374051	410374051	910374051
30	Pressuretrol PA404A1009	1	400117	400117	400117	400117	400117
31	Siphon - 1/4 NPT	1	400222	400222	400222	400222	400222
32	Tee - 1/4 x 1/4 x 1-1/4 brass	1	400223	400223	400223	400223	400223
33	Nipple - 1/4 x 2-1/2 long	1	400224	400224	400224	400224	400224
34	Nipple - 1/4 x close brass	1	400240	400240	400240	400240	400240
35	Elbow - 1/4 x 90 deg. brass	1	400232	400232	400232	400232	400232
36	Drain valve 3/4	1	400201	400201	400201	400201	400201
37	Reducing bushing - 1-1/2 NPT x 3/4 NPT	1	902179321	902179321	902179321	902179321	902179321
38	Plug square hd. - 1-1/2 NPT (skimmer tapping)	1	902342051	902342051	902342051	902342051	902342051
39	Thermostat - 24V hon T822D1537	1	400101	400101	400101	400101	N.A.
40	Primary control, White-Rodgers no. 668-415	1	4001191	4001191	4001191	4001191	N.A.
	Primary control, Honeywell R8184G	1	400119	400119	400119	400119	N.A.
41	Burner assembly, see #34 table 1	1	—	—	—	—	—
42	Tankless heater assy. (optional)	1	430080000	430080000	430080000	430080000	430080000
43	Control, low limit Honeywell L4006A2049(optional)	1	410527	410527	410527	410527	410527
44	Well 1/2 NPT x 1-1/2 ins. (optional)	1	410569	410569	410569	410569	410569
45	Plug 3/4 (for alternate L.W.C.O.)	1	902340051	902340051	902340051	902340051	902340051
46	Low water cut-off M&M PS 801-120 (optional)	1	430130	430130	430130	430130	430130
47	Low water cut-off M&M 67 (standard)	1	400116	400116	400116	400116	400116
48	Gasket, Beckett burner	1	430172	430172	430172	—	—
48A	Gasket, Carlin burner	1	430173	430173	430173	430173	430173

DETAIL OF CLEAN OUT AND
OBSERVATION DOOR ASSEMBLY

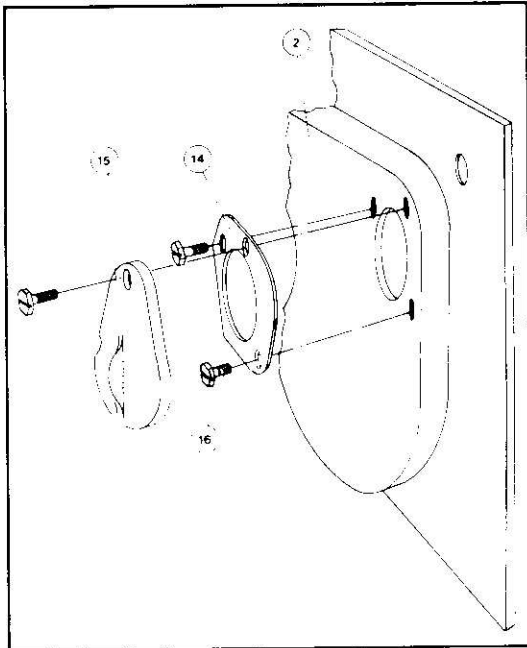

Figure 3

Slant/Fin

SLANT/FIN CORPORATION, 100 Forest Drive, Greenvale, New York 11548 • (516) 484-2600